



## Penthouse With Private Swimming Pool Burj Al Arab & Sea Views

Dubai, United Arab Emirates, Palm Jumeirah, Ocean House

Price on Application

Ref: S-700

Field Type

FIELD TYPE

**For Sale**

Property Status

STATUS

**Price on Application**

Property Type

TYPE

**Penthouse**

Bedrooms Icon

BEDROOMS

**5**

Bathrooms Icon

BATHROOMS

**6**

Area Icon

BUILT-UP AREA

**14036 sq ft**



TEREZAESTATES.COM

BUY | SELL | RENT

# Gallery

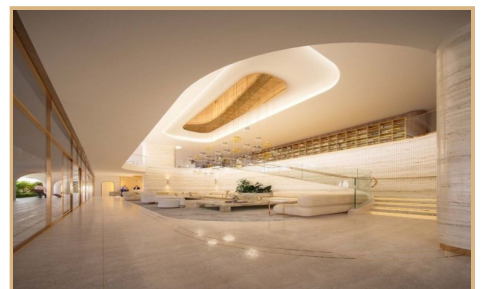
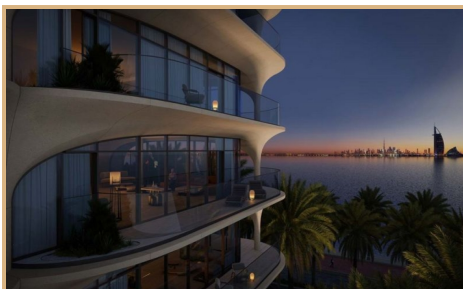
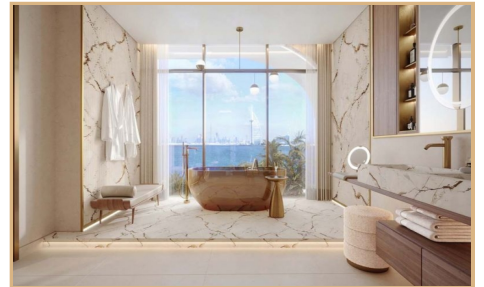



TEREZAESTATES.COM

BUY | SELL | RENT





# Property Description

**Location:** Dubai, United Arab Emirates, Palm Jumeirah, Ocean House

Tereza Estates is pleased to present this Exceptional Penthouse with Spectacular Sea & Burj Al Arab Views with your very own private swimming pool in The Ocean House, situated on the East Crescent of Palm Jumeirah.

Ocean House by Ellington has a unique architectural concept providing optimized views from all angles referred to as dual views where you can enjoy open sea views overlooking the sunset side, as well as Palm Jumeirah sea views.

This beautifully designed five bedroom penthouse spreads over a full floor size of 14036 sq.ft., featuring surrounding indoor-outdoor terrace throughout the entire penthouse suite with 5952 sq.ft. of internal area and 8083 sq.ft. of blissful outdoor space where you can enjoy truly breathtaking 360 views of all beauties of Dubai including Burj Al Arab and Downtown Dubai Skyline, as well as Marina Skyline and The Royal Atlantis, The Fronds and endless sea views from all aspects.

Private lift lobby access to welcome you back home in privacy, massive family living and dining as well as formal living and dining overlooking The Burj Al Arab and your private swimming pool at the expansive terrace space that also has its own outdoor kitchen and dining area to entertain your guests in style in a beautifully landscaped resort like residence. Includes prep kitchen and show kitchen, both equipped with kitchen appliances by Miele, Quartz countertops, as well as staff's quarter.

Massive master suite area that includes lounge and study and four fully ensuite secondary bedrooms.

Finishes will include natural marble stone flooring all throughout the living, dining and bedroom areas, with all of the five bedrooms being ensuite. Master bathroom includes his and hers sink, freestanding bathtub overlooking The Burj Al Arab along with walk-in rain-shower, sanitary ware and accessories to be all by Gessi, Geberit, Laufen or equivalent European grade with warm bronze touches. All of the bathrooms will be delivered fitted with bespoke medicine cabinets with integrated lighting and under sink storage, with soft closure finishes, and a warm subtle palette of colors in materials.

Wall and Ceiling paint all throughout to be Benjamin Moore or equivalent with matt finishes.

Meeting rooms, coworking spaces, state of the art gym, yoga room, spa treatment rooms, landscaped common areas with infinity swimming pool and beach access along with grand welcome Lobby with concierge services for restaurant bookings and other arrangements as well as valet parking services for residents and its visitors, Ocean House is truly a wonderful choice to go for when thinking of new residence at possibly the best address in the world - The Palm Jumeirah, Dubai.

Trakheesi Permit #0110865487

Estimated Completion Date: Q4 2025



## Key Features

- ✓ For Sale
- ✓ Built in Wardrobes
- ✓ Maid Service
- ✓ Security
- ✓ View of Water
- ✓ Concierge
- ✓ Private Garden
- ✓ Shared Spa
- ✓ Floor Area : 14036 sq ft
- ✓ Children's Play Area
- ✓ Pets Allowed
- ✓ Shared Pool
- ✓ Balcony
- ✓ Kitchen Appliances
- ✓ Private Pool
- ✓ Partly furnished
- ✓ Covered Parking
- ✓ Private Gym
- ✓ Study
- ✓ Central A/C
- ✓ Maids Room
- ✓ Shared Gym

