



# Sky Villa With Endless Sea & Sunset Views

**AED 38,100,000**

**Six Senses Residences The Palm, Palm Jumeirah, Dubai**

**Ref: S-693**

-  Field Type: For Sale
-  Property Status: Sold / Request Similar
-  Property Type: Villa
-  Number of Bedrooms: 4
-  Number of Bathrooms: 5
-  Area: 6454 sq ft



**TEREZAESTATES.COM**

BUY | SELL | RENT



# Gallery

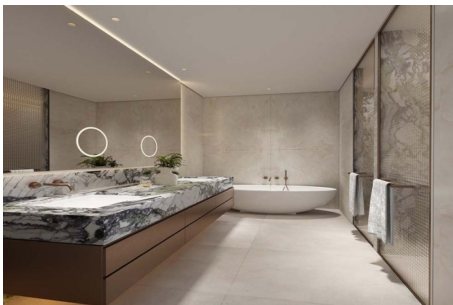
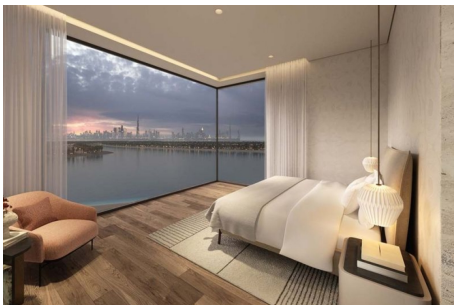

TEREZAESTATES.COM  
BUY | SELL | RENT

# Property Description

**Location:** Six Senses Residences The Palm, Palm Jumeirah, Dubai

Tereza Estates is delighted to present this Impeccable Duplex Sky Villa with Panoramic Open Sea & Sunset Views in The Six Senses Residences, The Palm, Dubai located on the serene West Crescent of Palm Jumeirah with direct access to its private pristine beach with crystal clear waters of the Arabian Sea.

This beautifully designed four bedroom luxury sky villa comprises of a massive built up area of 6,454 sq.ft. with absolutely impeccable finishes and interior touches where nature is the main inspiration for the architectural narrative of the Penthouses at Six Senses Residences, The Palm, Dubai.

Combining elements of natural stones, wooden floorings and other precious stone material details on finishes that include massive marble kitchen islands with fully integrated branded kitchen appliances or beautifully designed bathrooms with lots of natural light, floor to ceiling windows with ceiling heights of 3,2 meters embracing the mesmerizing views of the sea and Dubai's impressive Skyline architecture, ensuring bright and light feel in every penthouse or a sky villa throughout the resort that spreads over a massive area of 75,000 square meters offering its residents a true luxury beachfront getaway resort feel home with incomparable lifestyle and wellness facilities that include the infamous Six Senses Spa with wide range of wellness treatments helping you to reconnect to all your senses, while retaining the intimacy of a spectacular home for a lifetime at the most demanded address of Dubai - The Palm Jumeirah.

Residential owners and guests can benefit from beautifully landscaped lush green gardens throughout the completely car-free resort, Six Senses Veggies and Fruits organic garden and other lifestyle facilities that include private beach and infinity swimming pool as well as massage circuit pool, gym squash court, wellness circuit, shared business hubs and meeting rooms, residents lounges, fine dining restaurants throughout the resort and many others.

Six Senses is an exclusive members community with worldwide resorts across 17 different countries including destinations like Uluwatu on Bali, tropical Island of Fiji, the favourite Courchevel of French Alps, Douro Valley in Portugal, the magical island of Ibiza, as well as historical city of Rome, Six Senses Laamu in Maldives, Shahrut in Israel, Butan, Krabey Island, Qing Cheng Mountain (part of UNESCO World heritage), Fort Barwara, Vana and many others, with the closest one to Dubai being beloved Zighy Bay in Oman.

Trakheesi Permit #1097311822

Estimated Completion Date: Q4 2024



TEREZAESTATES.COM

BUY | SELL | RENT

# Additional Info

For Sale	Floor Area : 6454 sq ft	Partly furnished
Built in Wardrobes	Children's Play Area	Covered Parking
Maid Service	Pets Allowed	Private Gym
Private Pool	Shared Gym	Shared Spa
View of Landmark	Walk-in Closet	Balcony
Central A/C	Concierge	Kitchen Appliances
Maids Room	Private Garden	Private Jacuzzi
Security		

# Amenities